

CALCULATING GUIDE FOR ROOFING SQ. FOOTAGE

Substitute the formulas given under each type of roof to obtain actual square foot area for the following roofs:

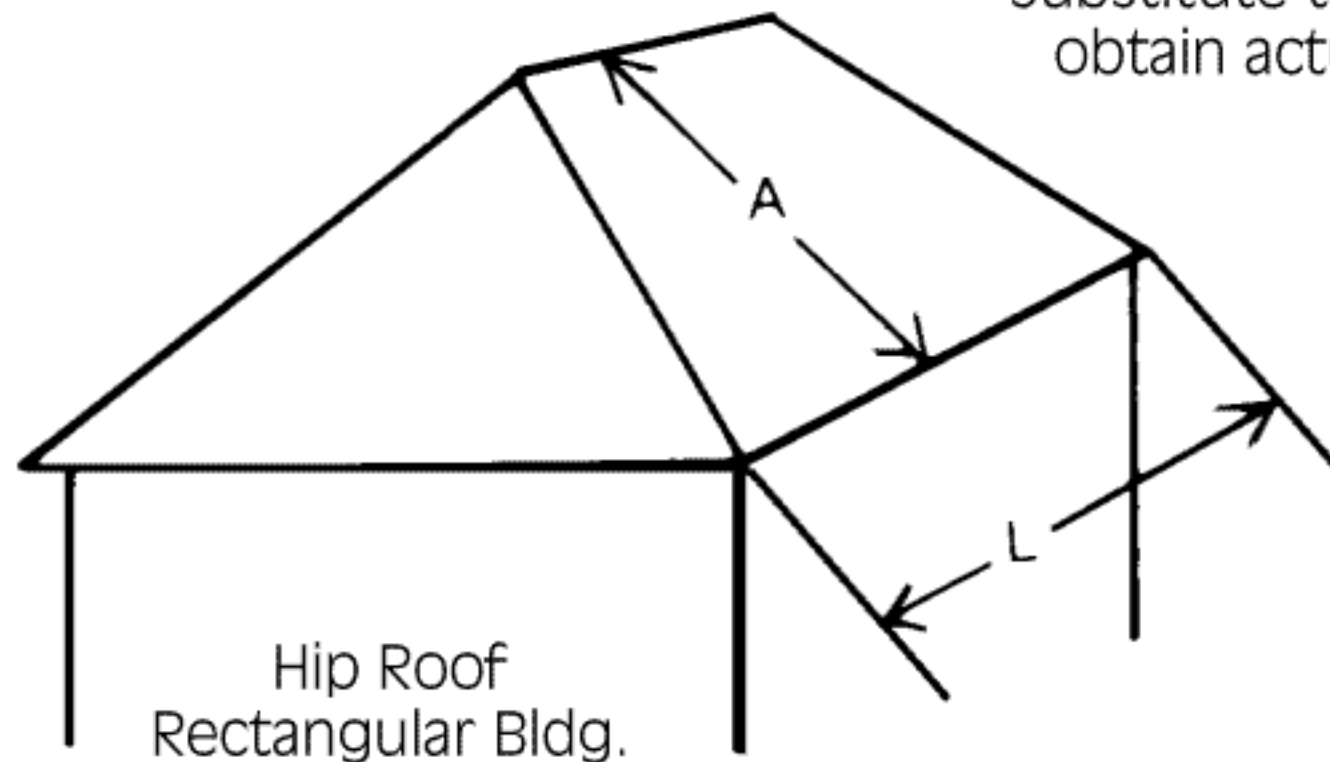

Hip Roof
Rectangular Bldg.
Area = $2 \times A \times L$

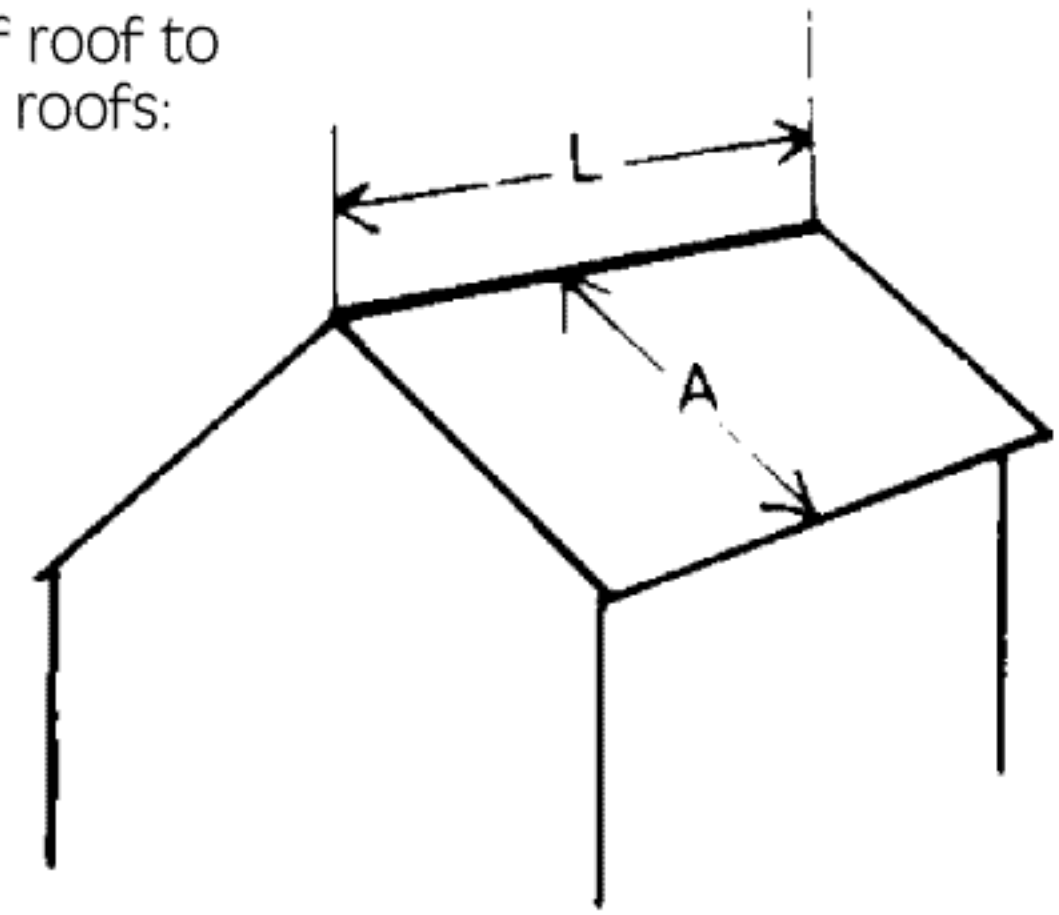

Gable Roof
Area = $2 \times A \times L$

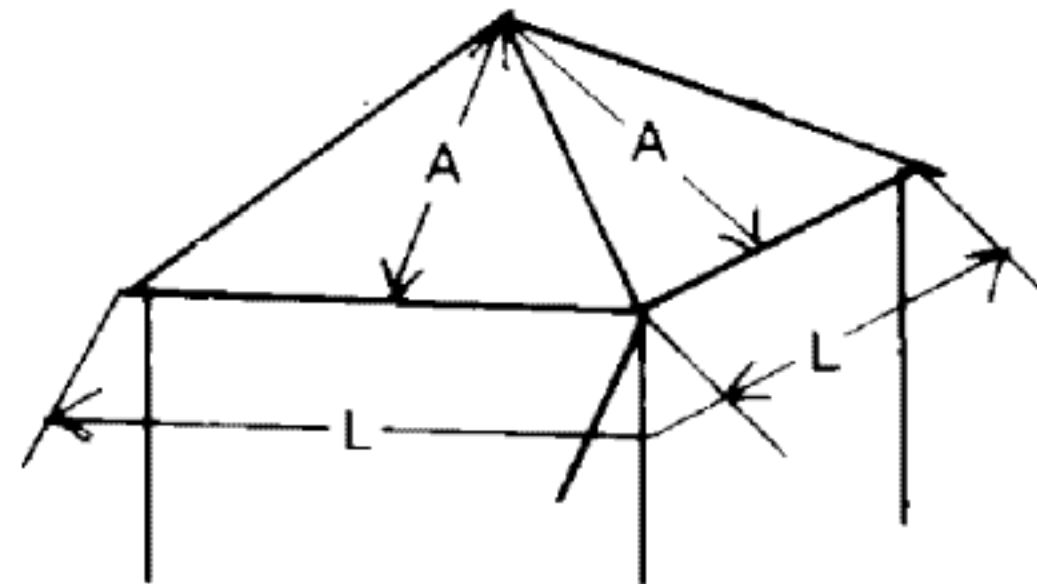

Hip Roof
Square Bldg.
Area = $2 \times A \times L$ or
 $2 \times A' \times L'$

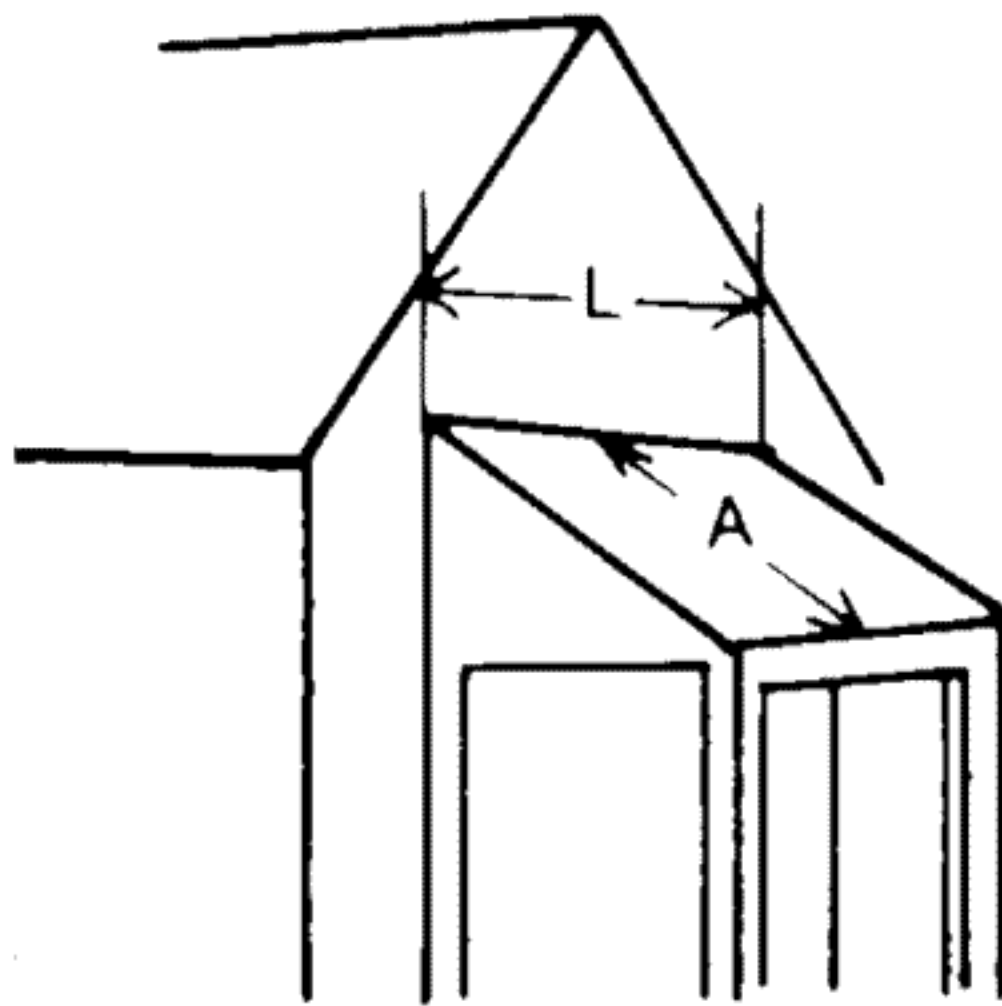

Shed Roof
Area = $A \times L$

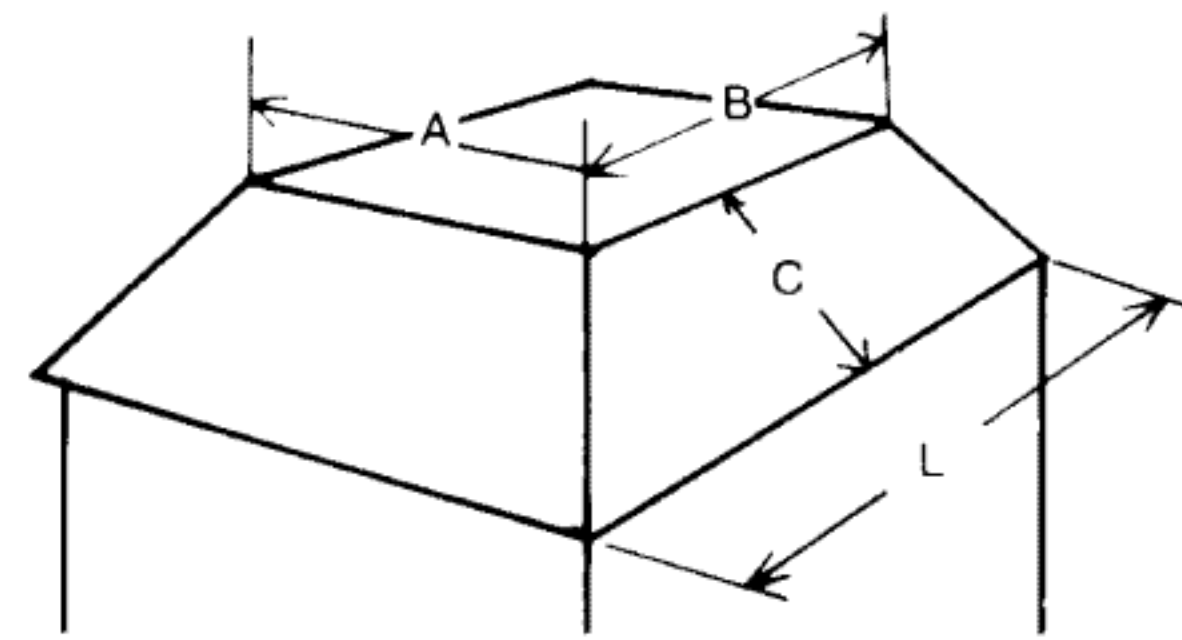

Mansard Roof
Area =
 $(2 \times A \times C) + (2 \times C \times L) + (A \times B)$

DOOR HANDING & HARDWARE

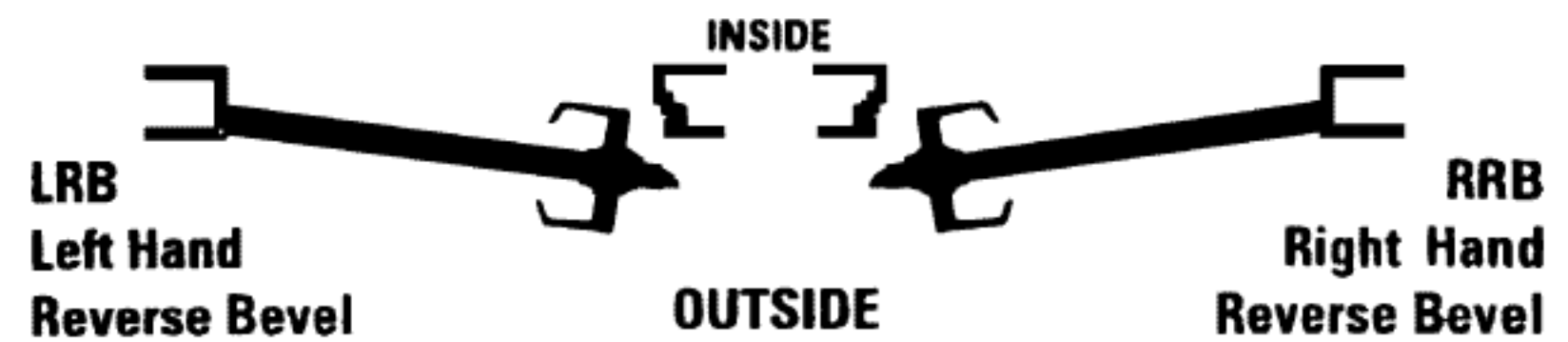
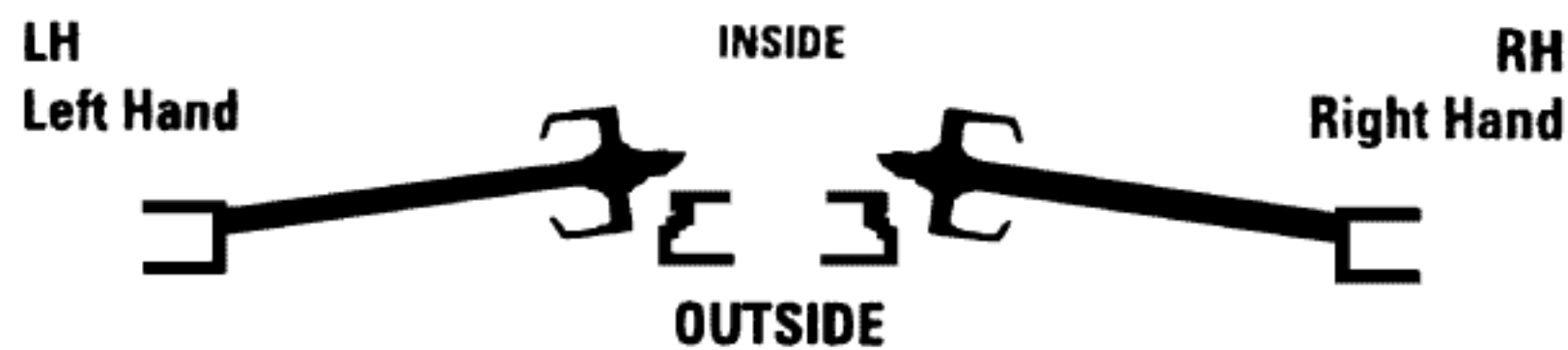

U.S. STANDARD FINISHES	DESCRIPTION OF FINISH	BHMA
1B	Bright Black	601
2G	Plain Zinc Plate	603
3	Bright Brass	605
4	Satin Brass	606
5	Satin Brass, Oxidized	609
7	Bright Brass, Nickel Oxidized & Highlighted	610
9	Bright Bronze	611
9A	Bright Bronze, No Lacquer	N/A
10	Satin Bronze	612
10A	Antique Bronze, Lacquered	641
10B	Antique Bronze, Oiled	613
14	Bright Nickel	618

U.S. STANDARD FINISHES	DESCRIPTION OF FINISH	BHMA
14A	Bright Nickel, Oxidized & Highlighted	N/A
14B	Black Nickel, Bright	N/A
15	Satin Nickel	619
15A	Satin Nickel, Nickel Oxidized & Highlighted	620
17A	Black Nickel, Dull	621
20	Statuary Bronze, Light	623
20A	Statuary Bronze, Dark	624
26	Bright Chromium Plated	625
26D	Satin Chromium Plated	626
32	Stainless Steel Metal, Bright	629
32D	Stainless Steel Metal, Satin	630
USP	Prime Coat	600